

«Mondeo 2001 Table of Contents»

«Group 3: Powertrain»

«Section 308-00: MANUAL TRANSMISSION/TRANSAXLE AND CLUTCH - GENERAL INFORMATION»

«GENERAL PROCEDURES»

Gearshift Cable Adjustment — Vehicles With: MTX-75/5-Speed Manual Transaxle (165130)

Special Service Tool(s)

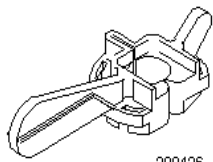

308436

Aligner, Gear Shift Lever 308-436 (16-097)

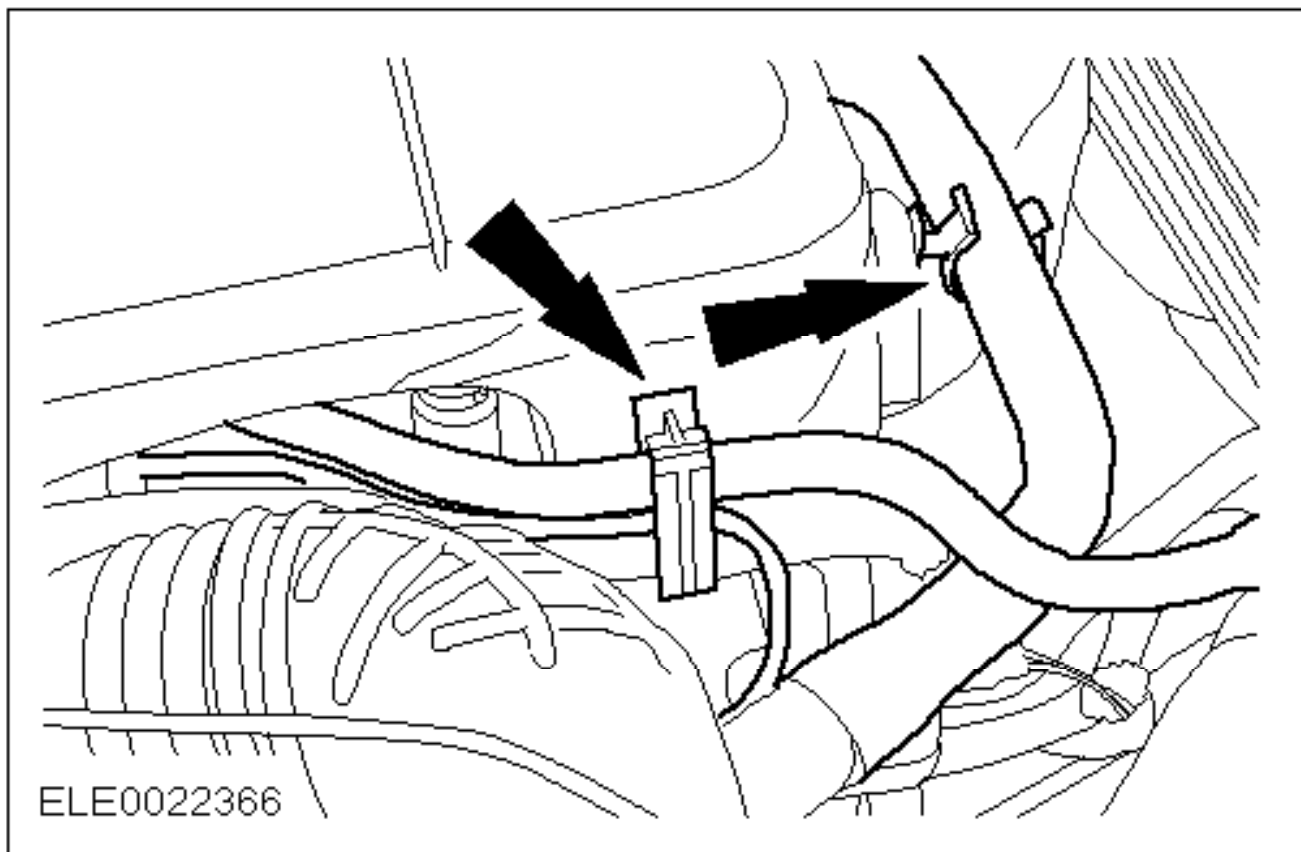

All vehicles

1. Detach the positive crankcase ventilation (PCV) hose and the vacuum hose from the engine cover.

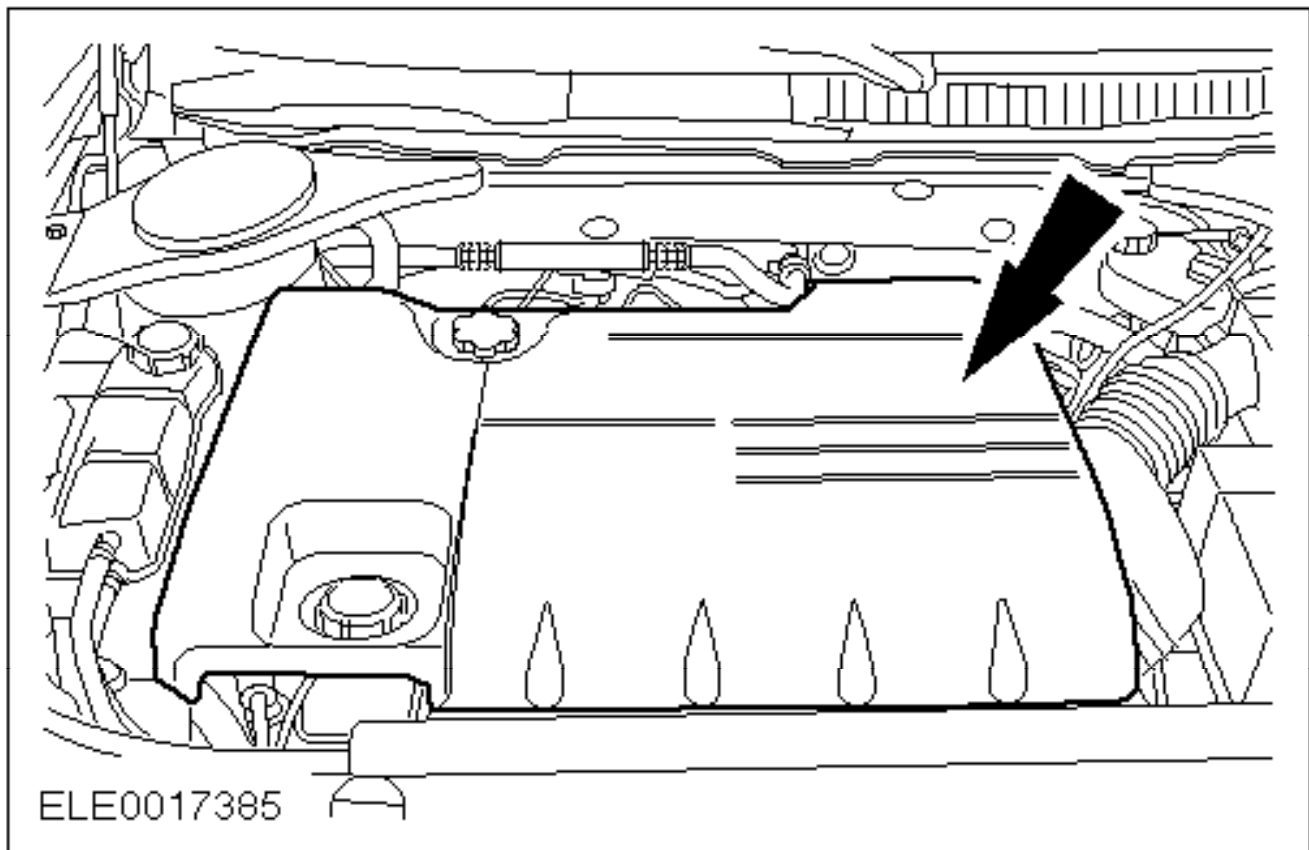

2. Remove the engine cover.

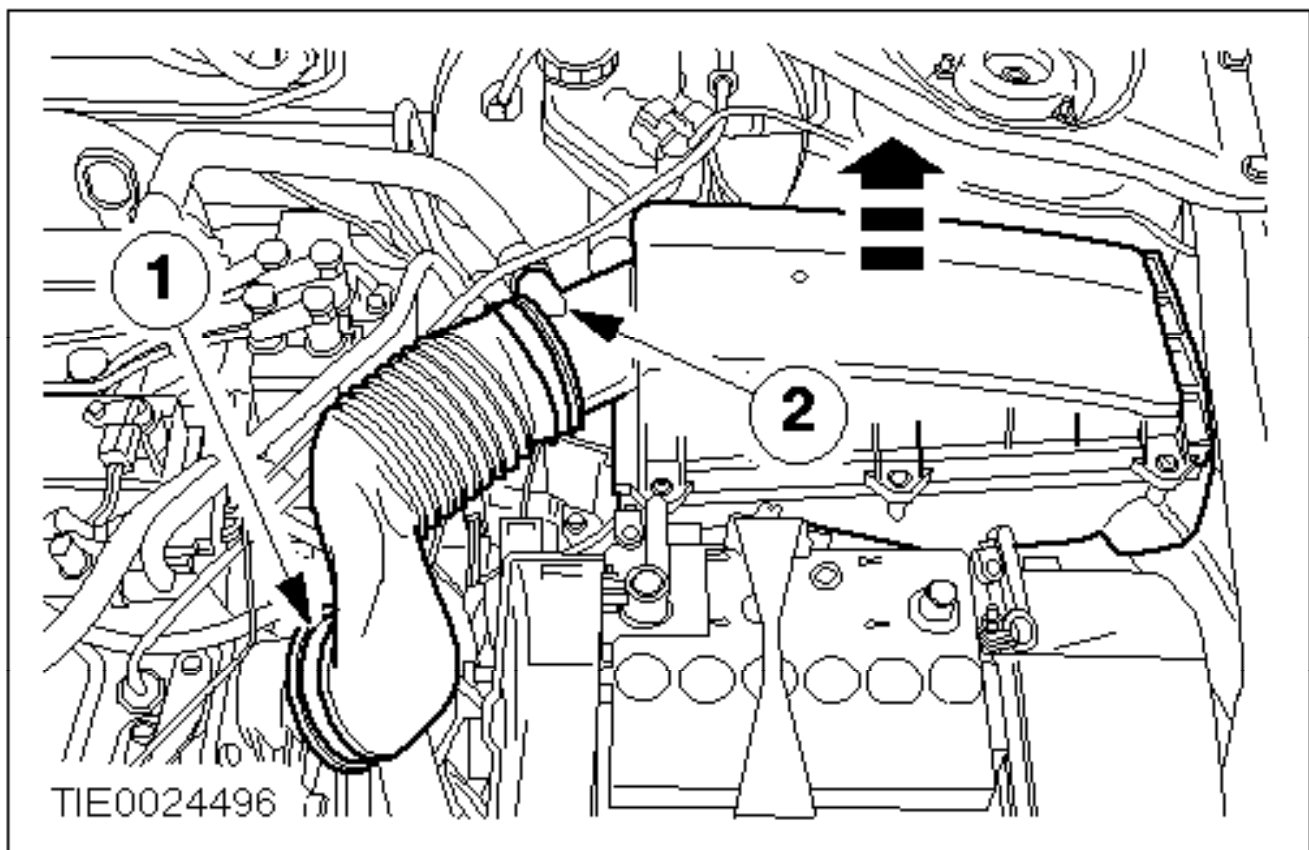

3. Remove the air cleaner.

- 1 Detach the clamp of the air cleaner intake hose to the engine.
- 2 Detach the positive crankcase ventilation (PCV) hose from the air cleaner.

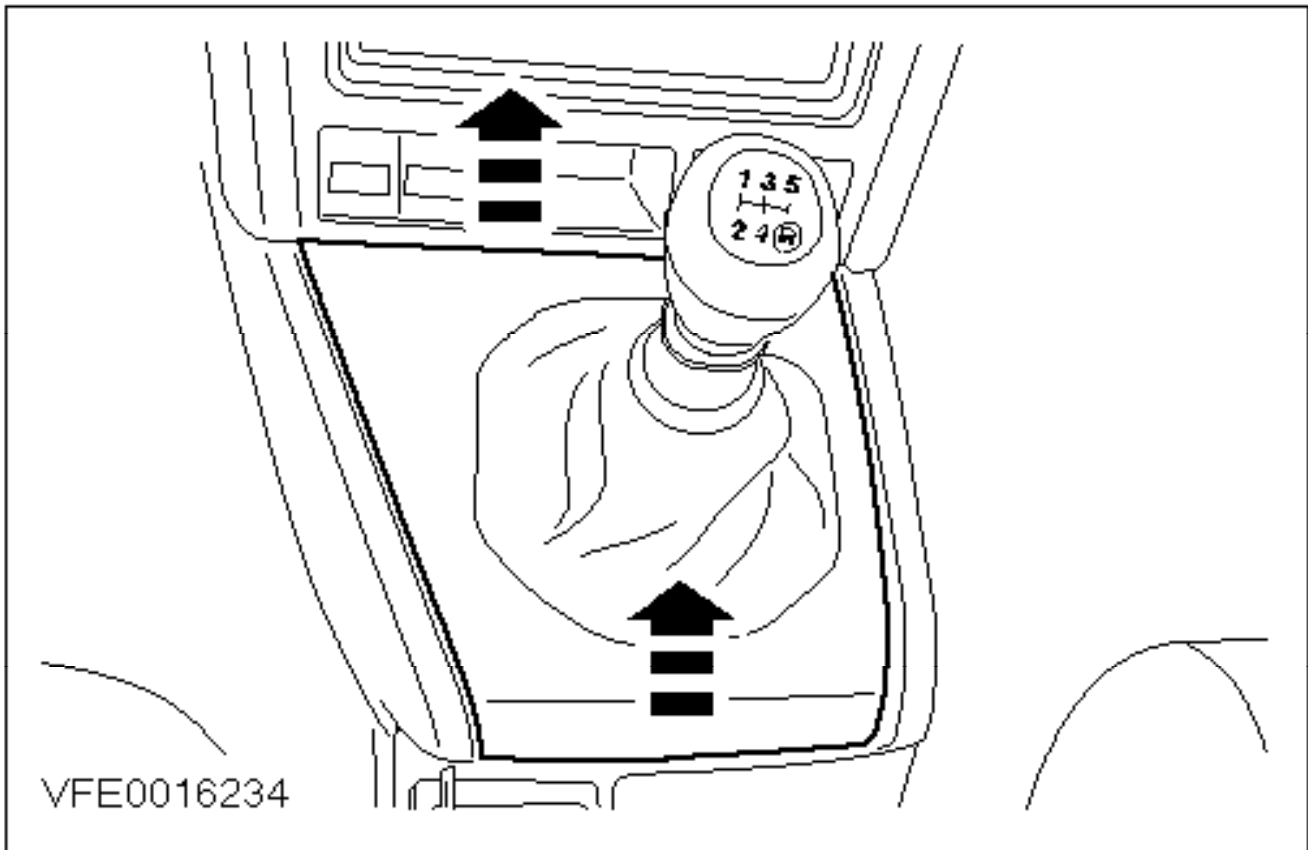

4. **Note:**
Move the gearshift lever to the neutral position.
Remove the gearshift lever gaiter and trim panel from the center console.
- Remove the damping matting.

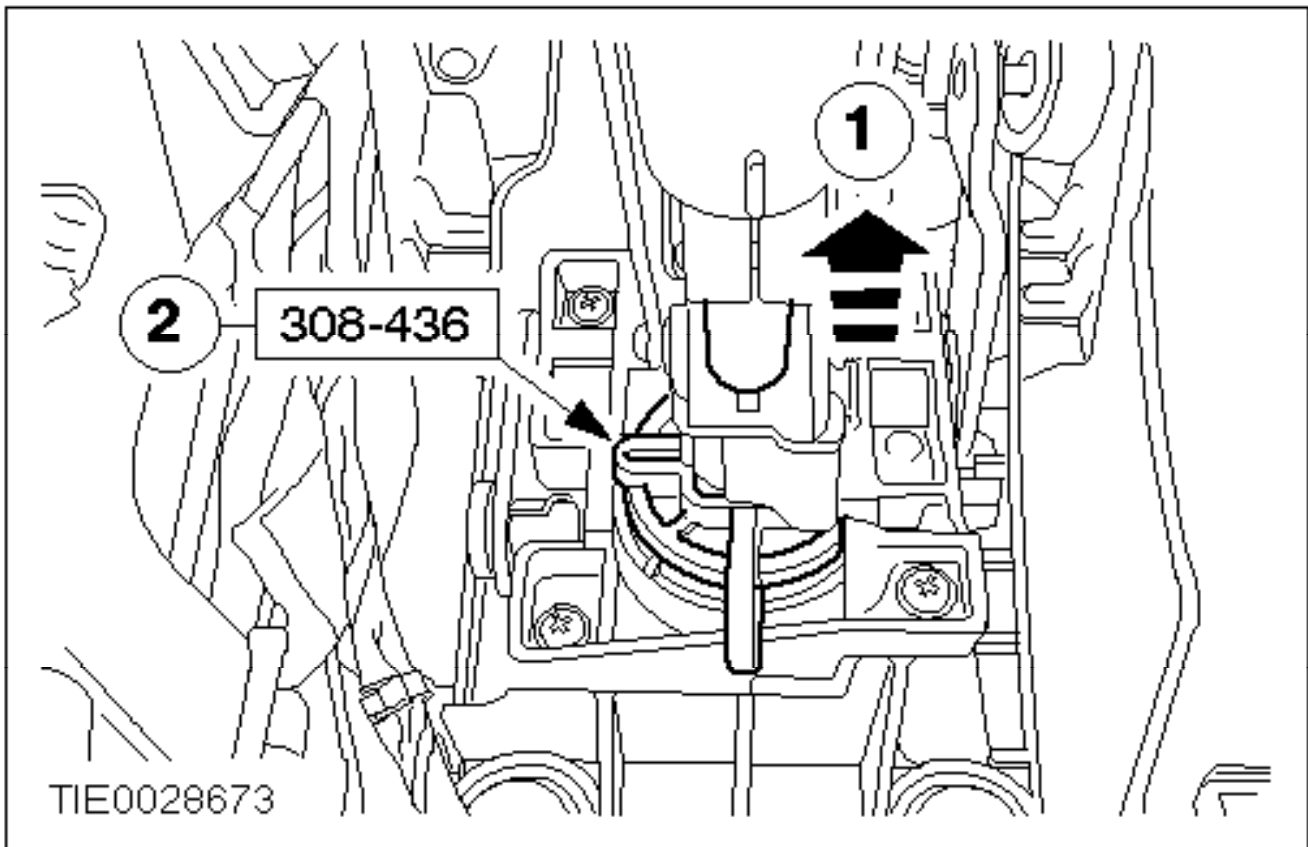

Vehicles built up to 06/2003

5. Lock the gearshift lever using the special tool.

- 1 Pull the reverse gear lock upwards.
- 2 Attach the special tool.

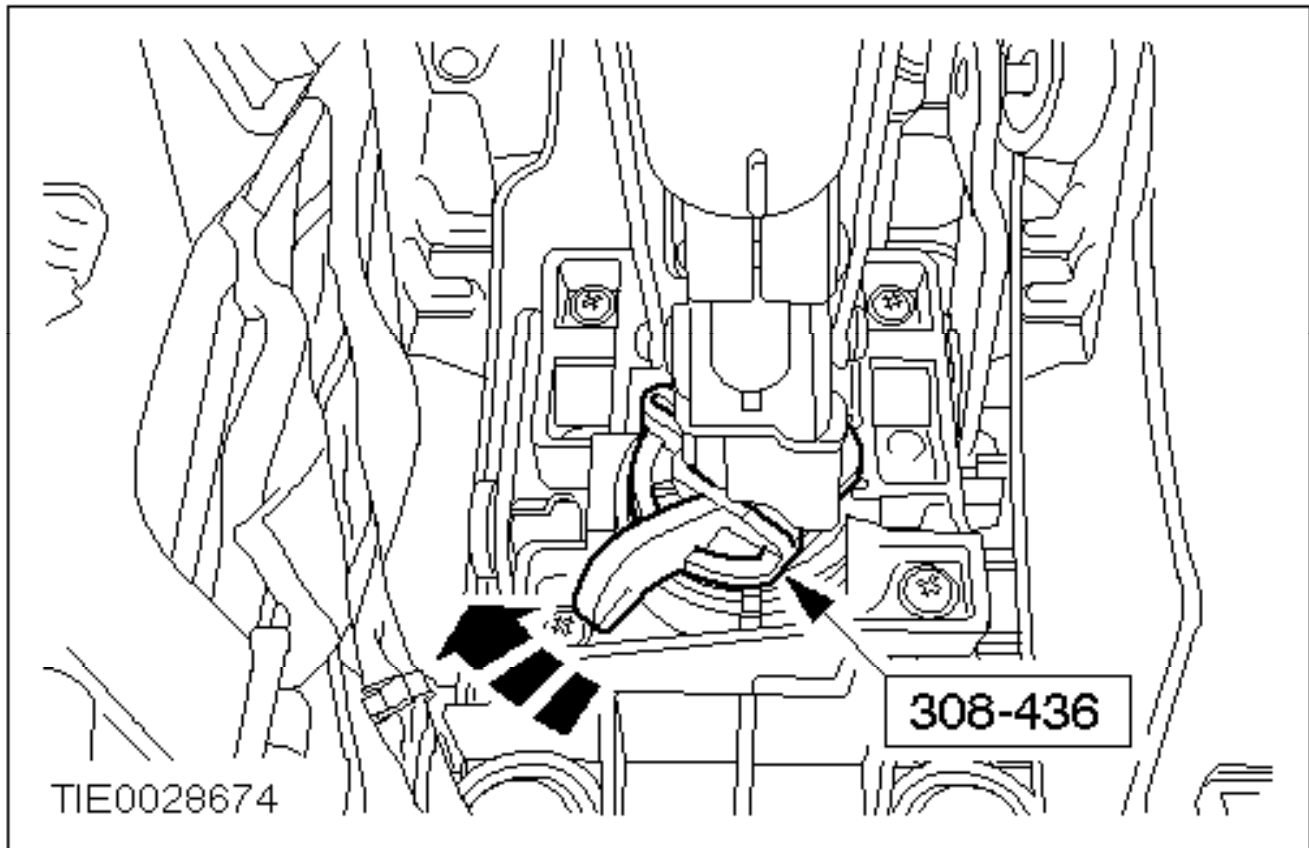

6. Turn the special tool approx. 45 degrees clockwise in order to lock the selector mechanism.
7. Raise the vehicle.

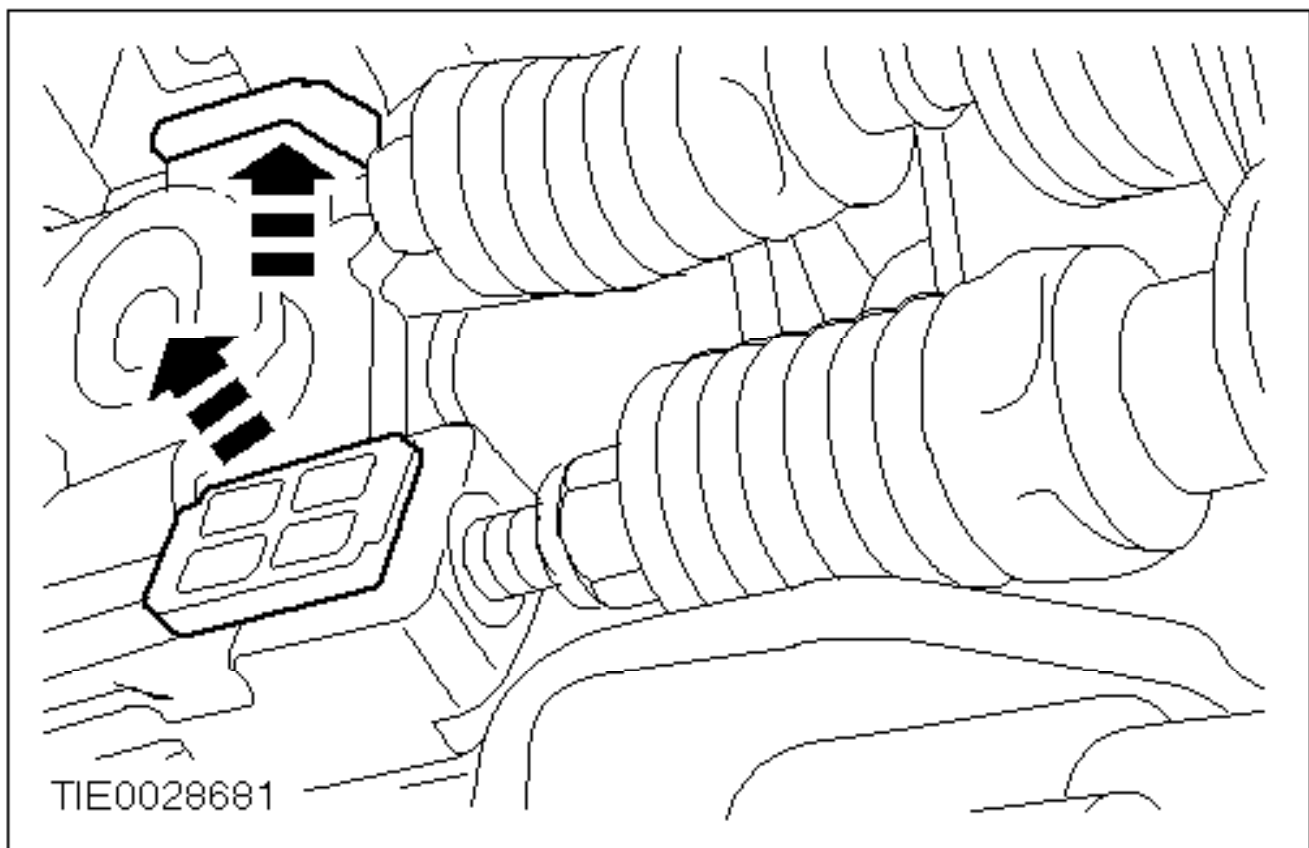

8. Release the catches for the gearshift cable and selector cable.

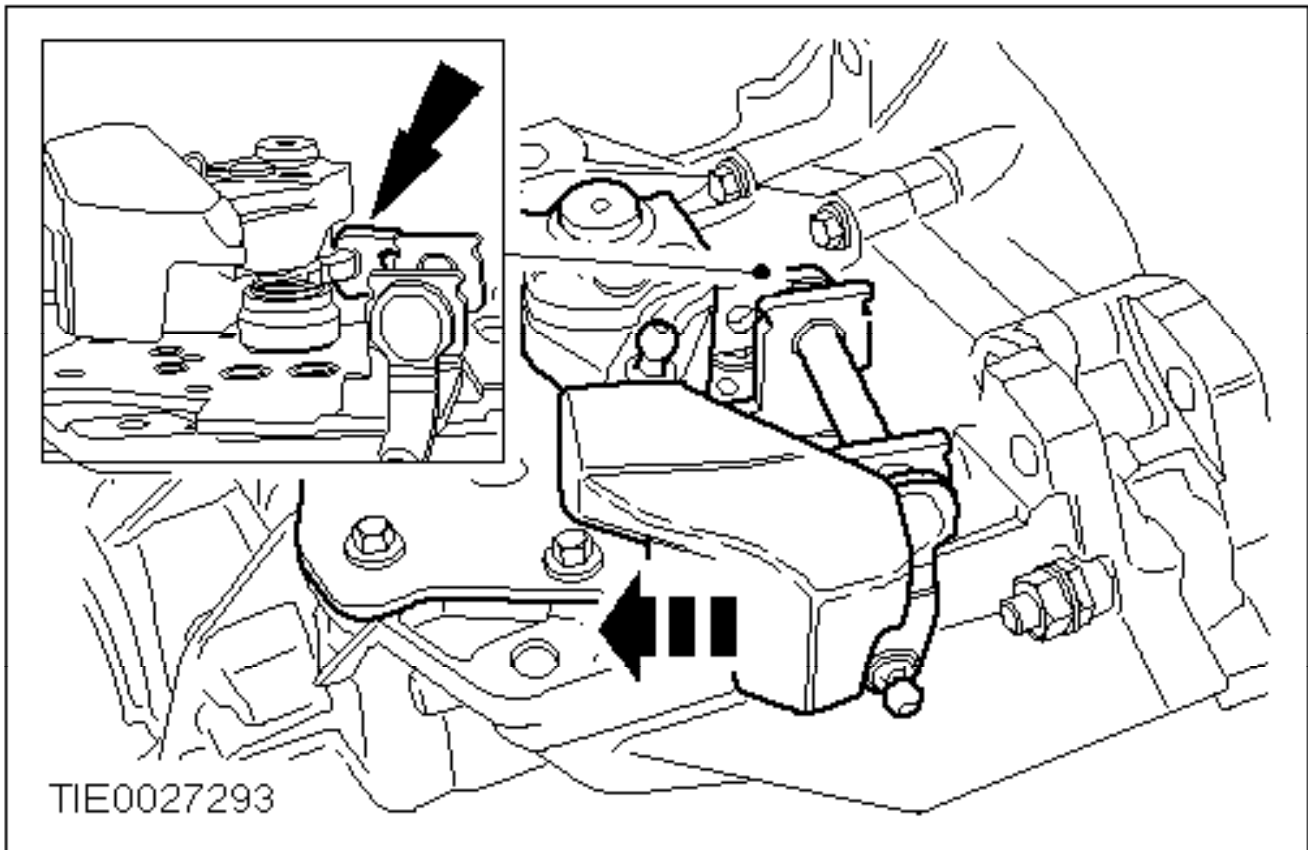

9. **Note:**
3rd gear is engaged when the elbow is parallel to the base plate, as shown (gearshift cables not shown).
Engage third gear.

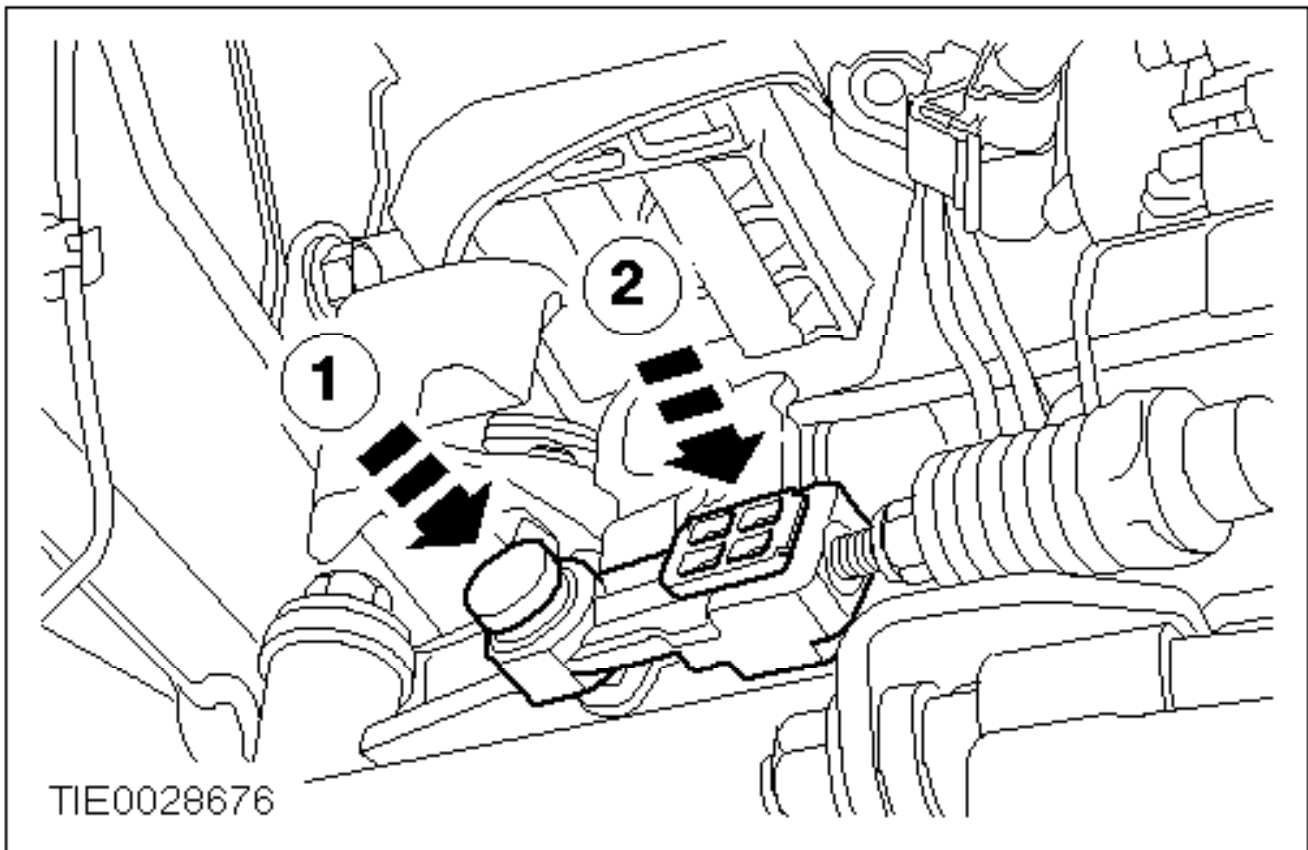

10. Attach the selector cable to the selector lever.
1 Attach the selector cable (black) to the selector lever.

- 2 Adjust the selector cable by pressing in the catch.

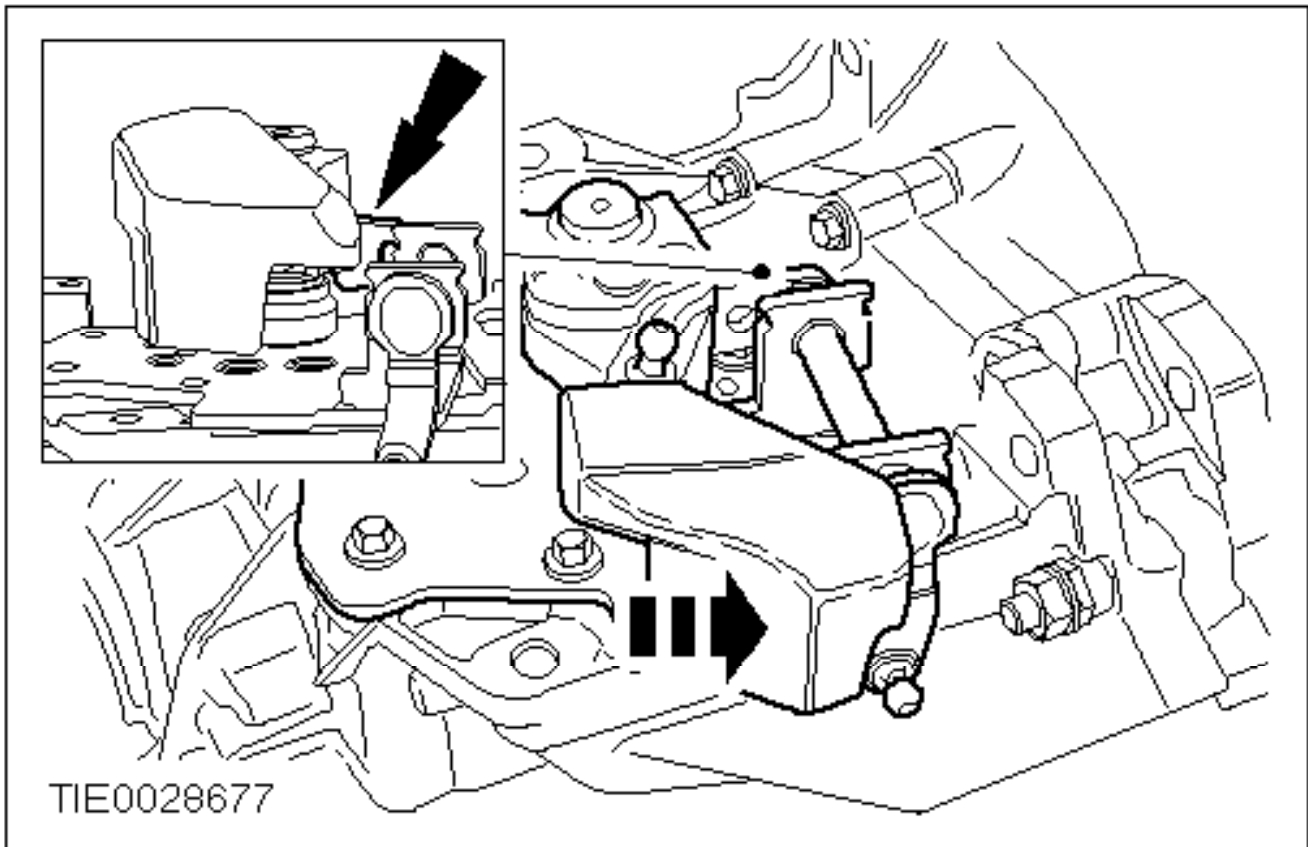

11. Shift the transmission into neutral (gearshift cables not shown).

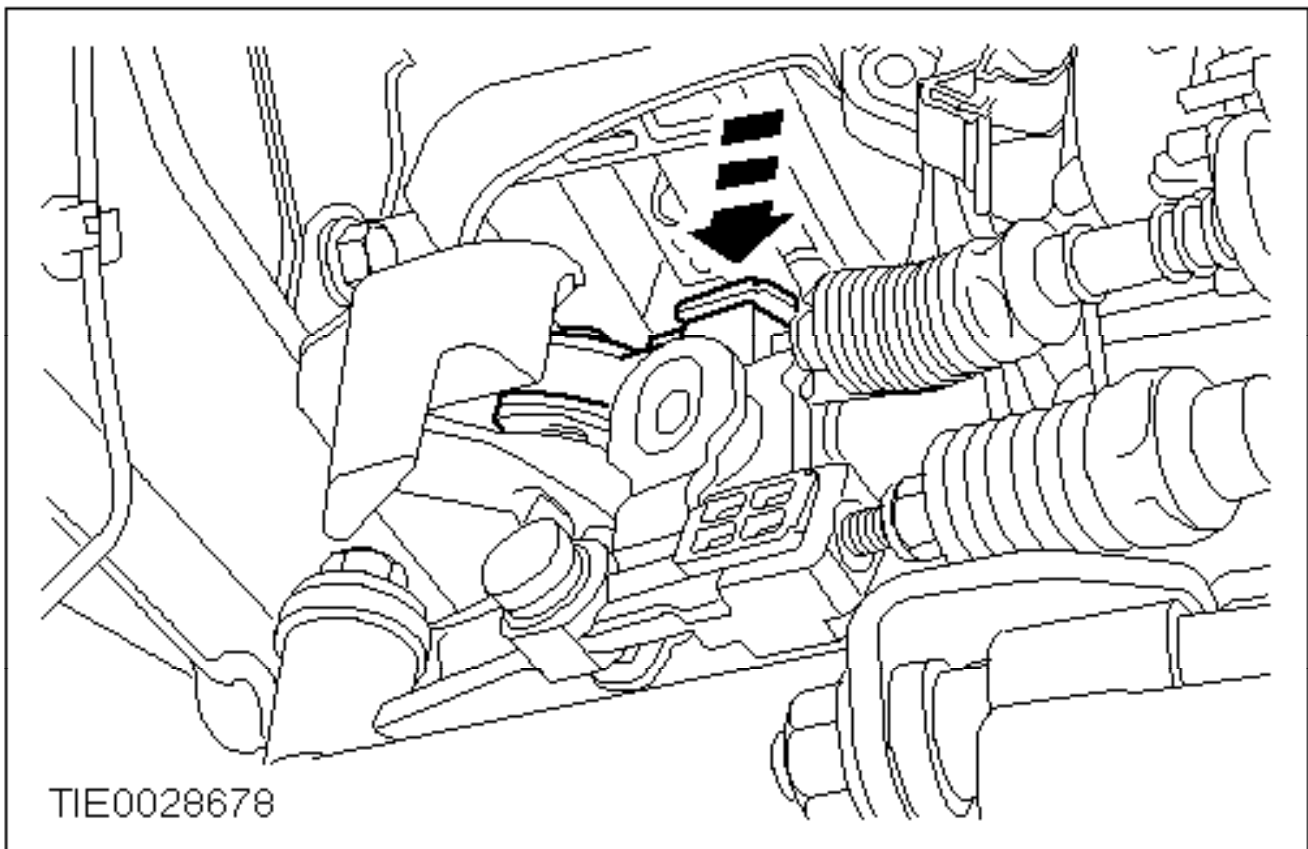

12. Attach the gearshift cable to the gearshift lever (if previously detached).
 - 1 Attach the gearshift cable (white) to the gearshift lever.
 - 2 Adjust the gearshift cable by pressing in the catch.

13. Lower the vehicle.

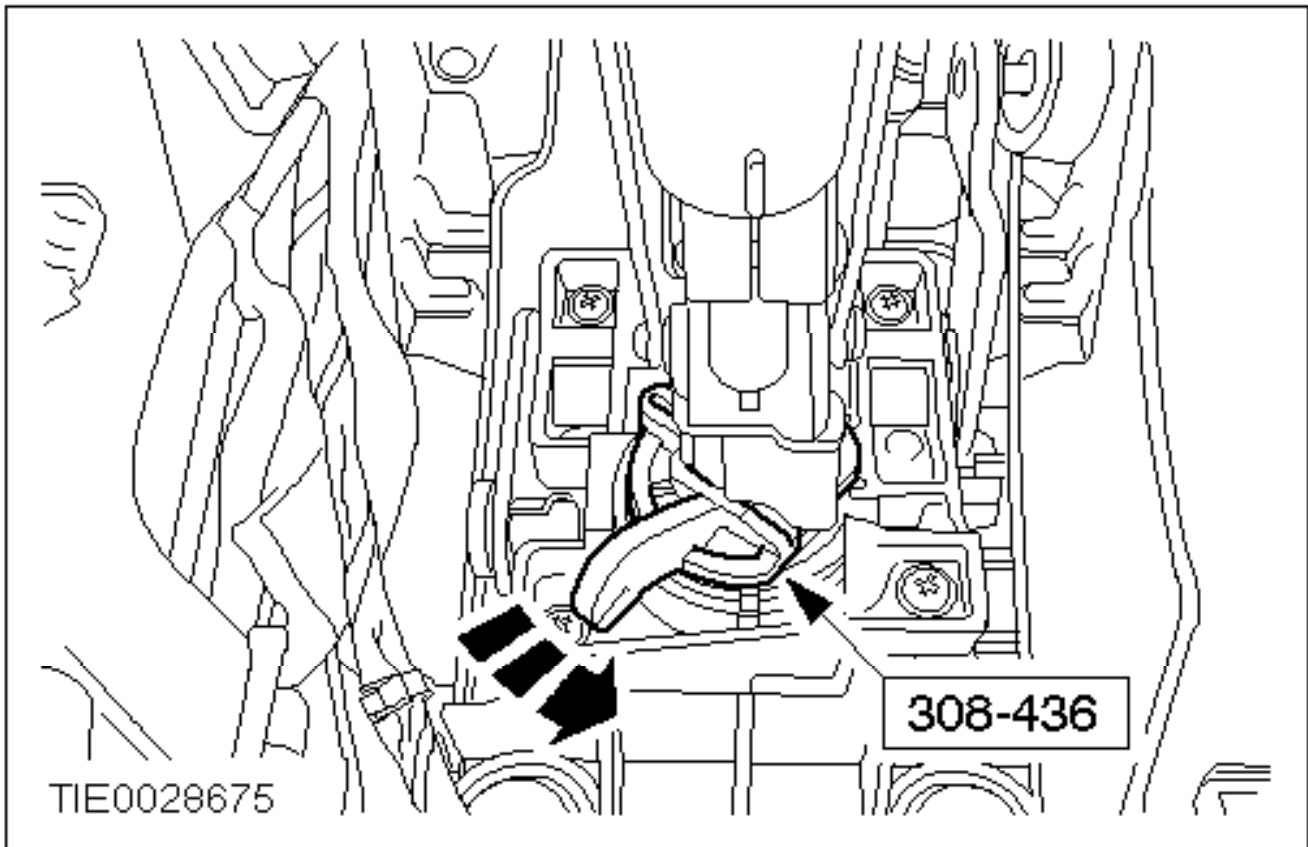

14. Turn the special tool counter-clockwise through approx. 45 degrees in order to release the selector mechanism.

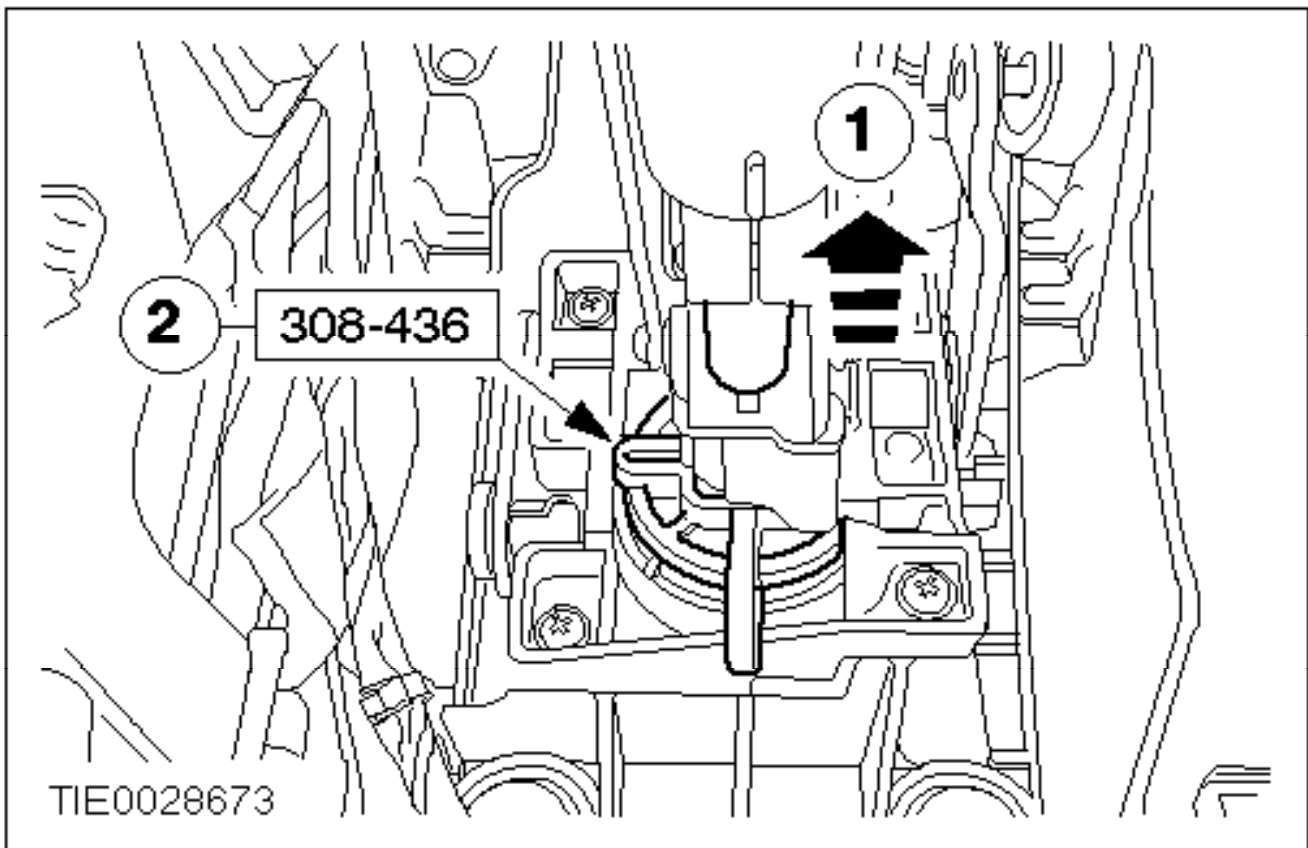

15. Remove the special tool.
- 1 Pull the reverse gear lock upwards.
 - 2 Remove the special tool.

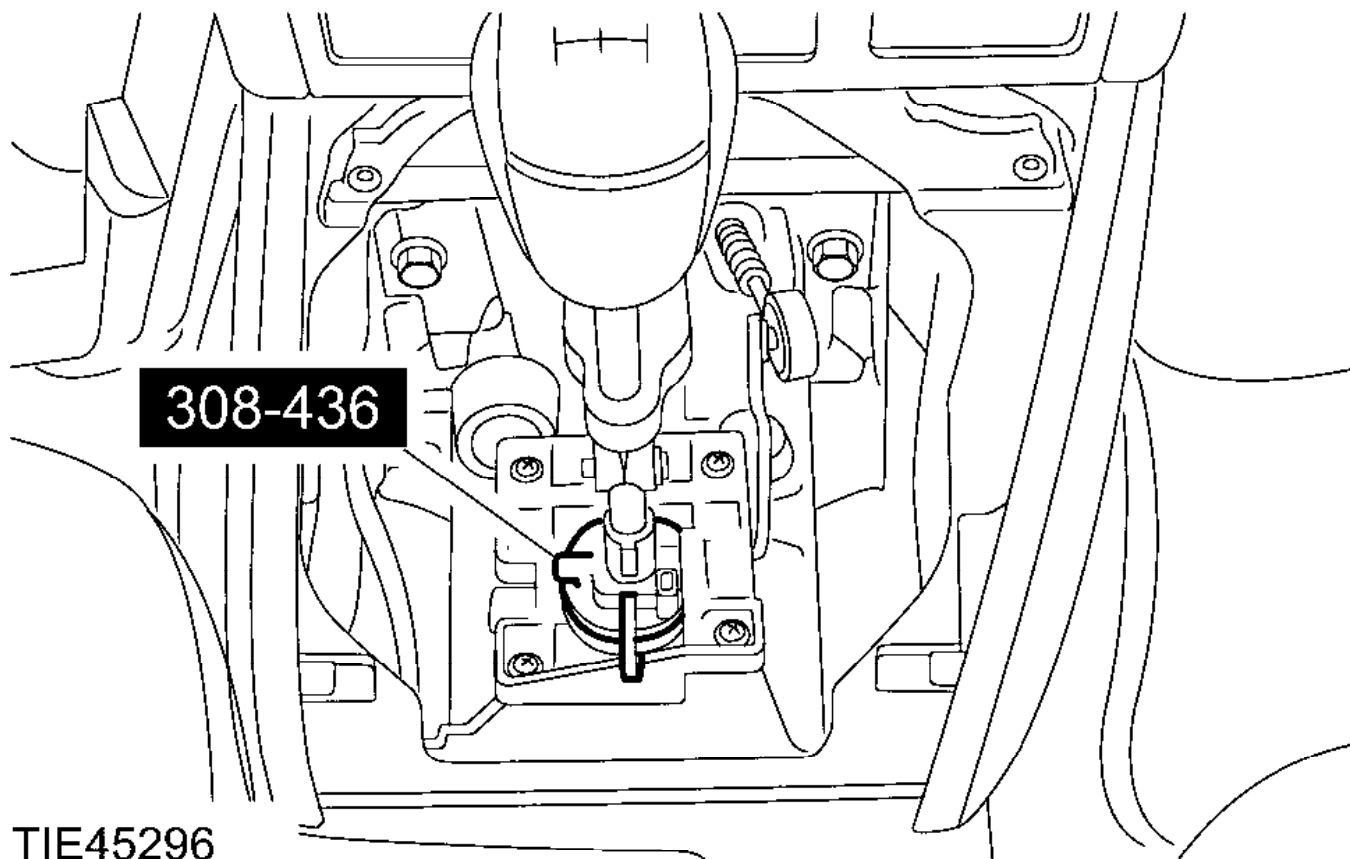

TIE45296

Vehicles built from 06/2003

- 16. Lock the gearshift lever using the special tool.

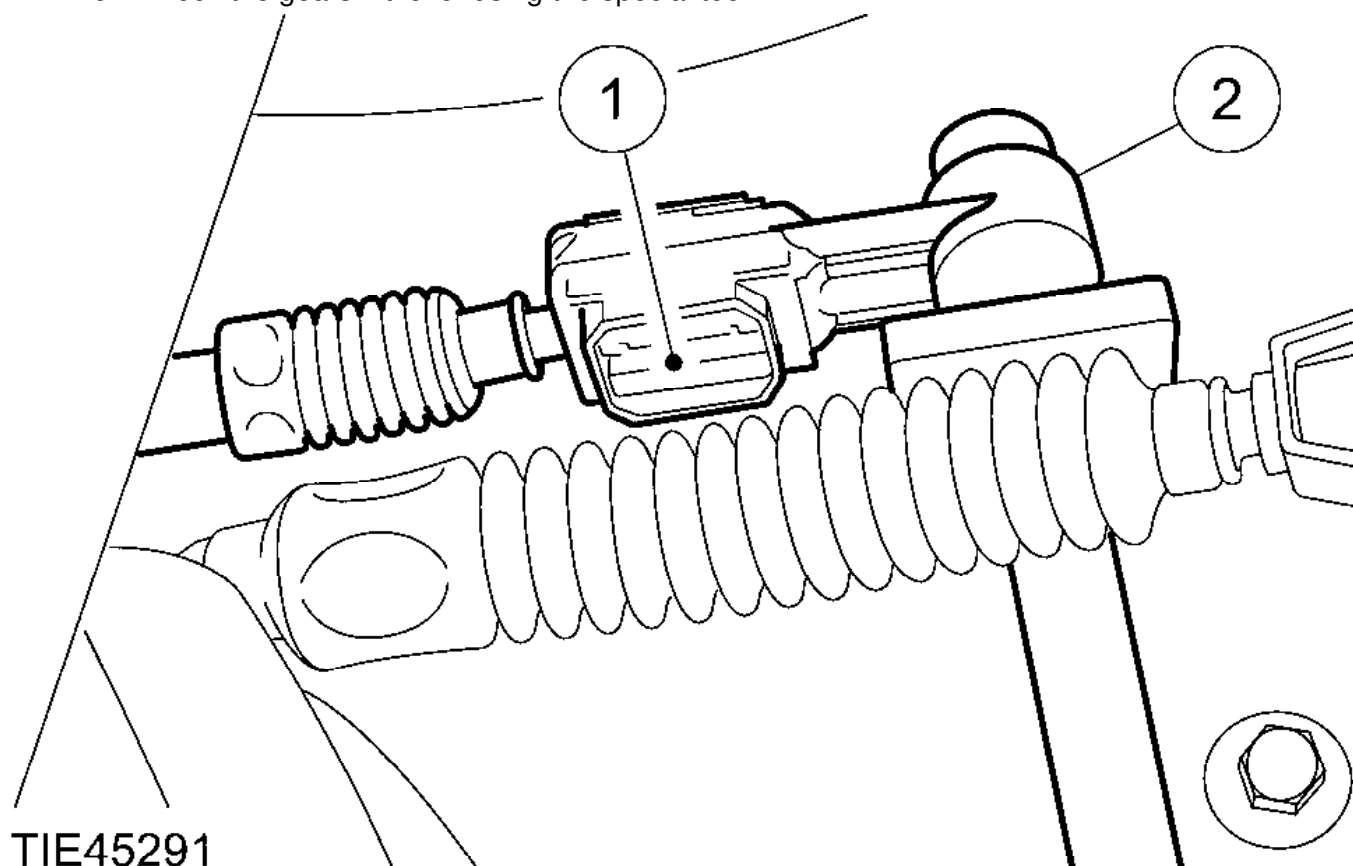

TIE45291

- 17. Detach the selector cable from the selector lever.
 - 1 Release the selector cable adjuster.
 - 2 Press the selector cable catch.

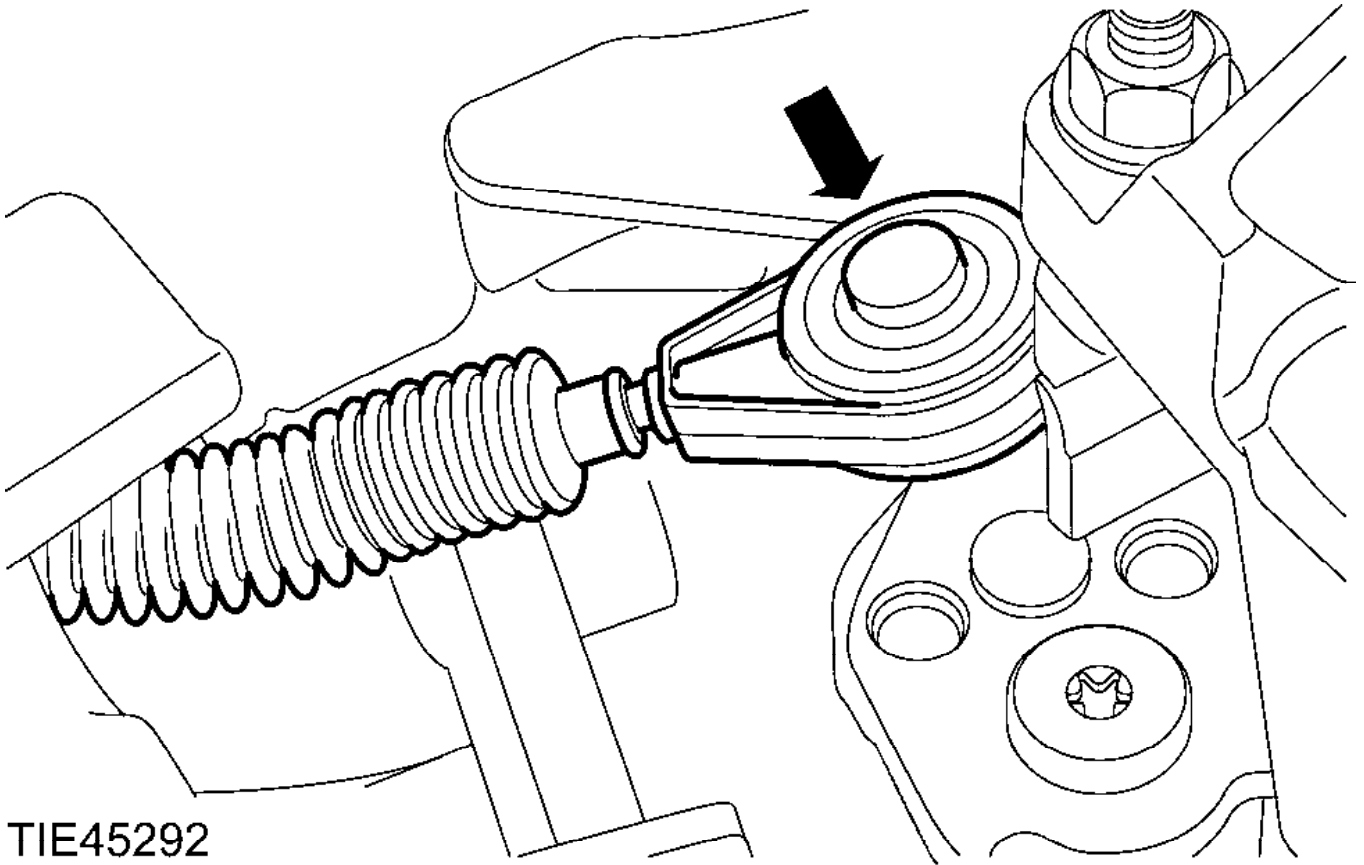

TIE45292

- 18. Detach the gearshift cable from the gearshift lever.
 - Press the gearshift cable catch.

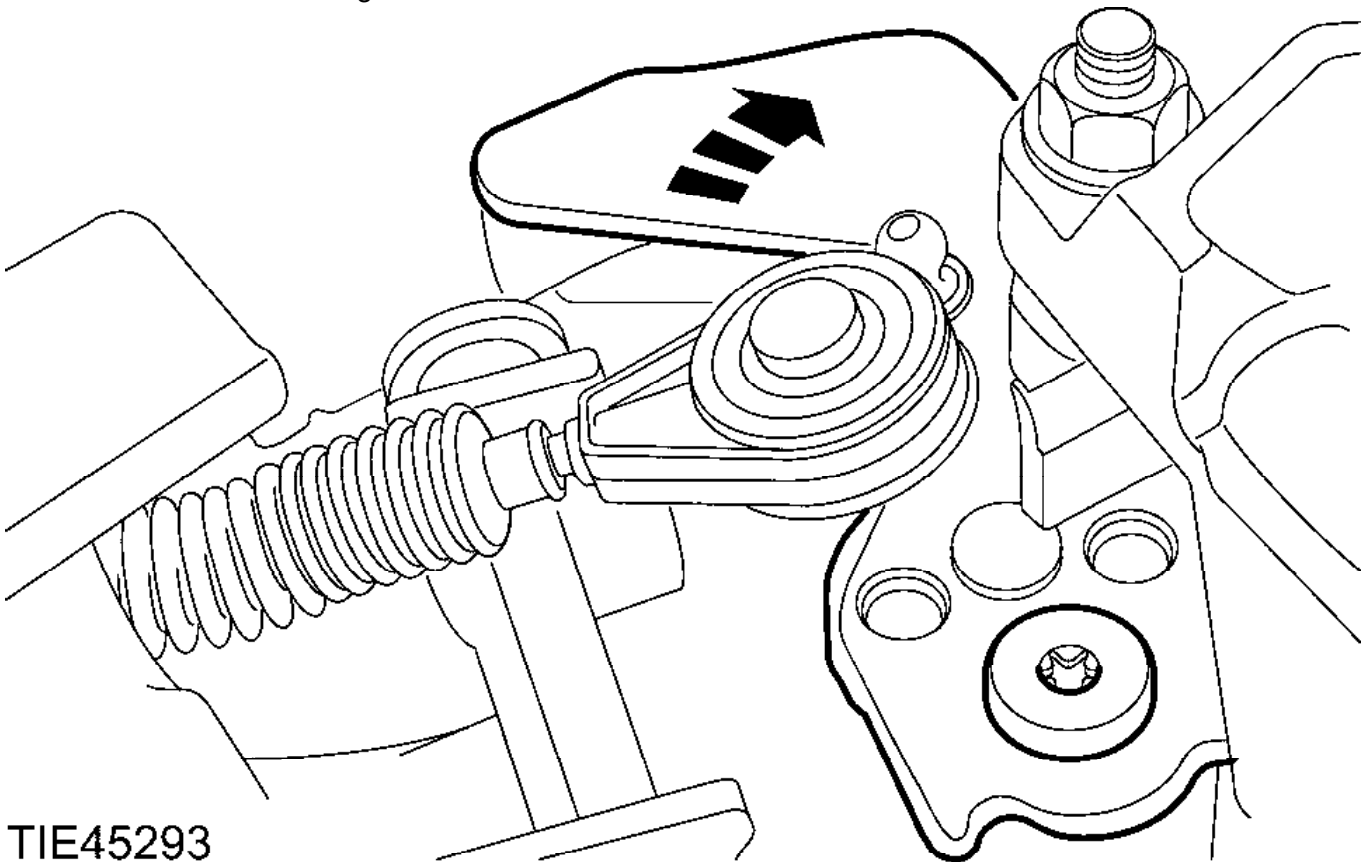

TIE45293

- 19. Shift the transmission into 3rd gear.

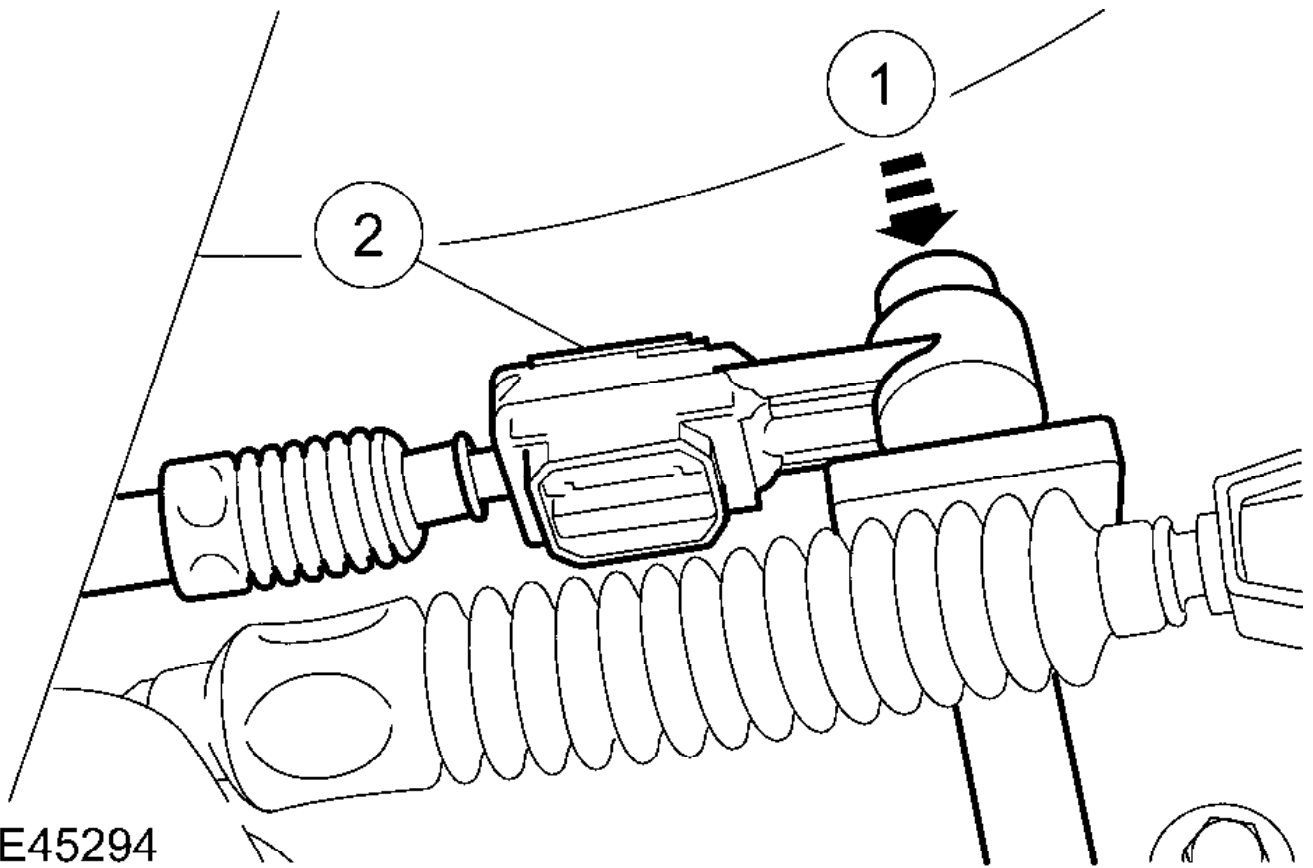

TIE45294

20. Adjust the selector cable.

- 1 Press the selector cable catch and attach the selector cable to the selector lever.
- 2 Lock the selector cable adjuster.

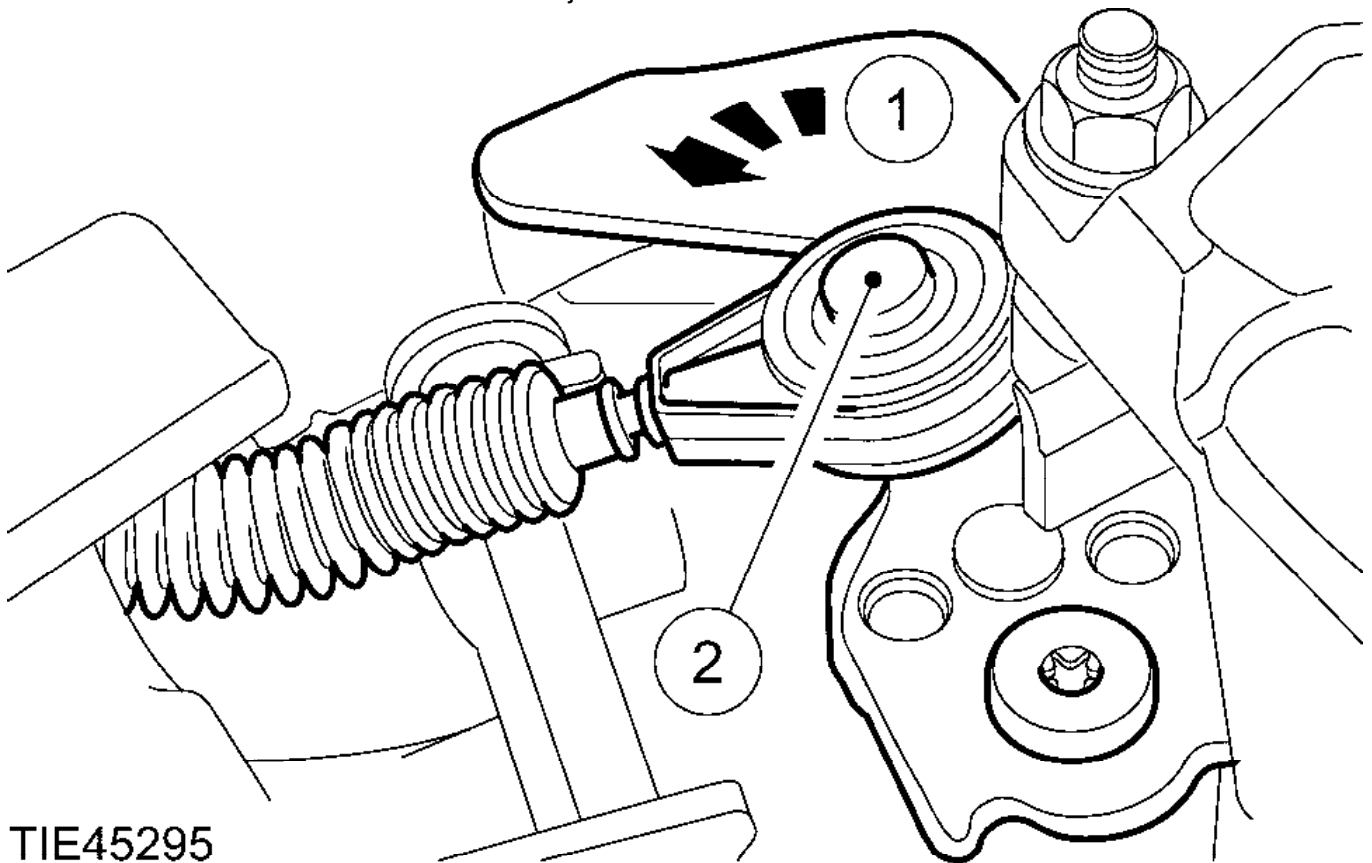

TIE45295

21. Attach the gearshift cable to the gearshift lever.

- 1 Shift the transmission into neutral.

- 2 Press the gearshift cable catch and attach the gearshift cable to the gear lever.

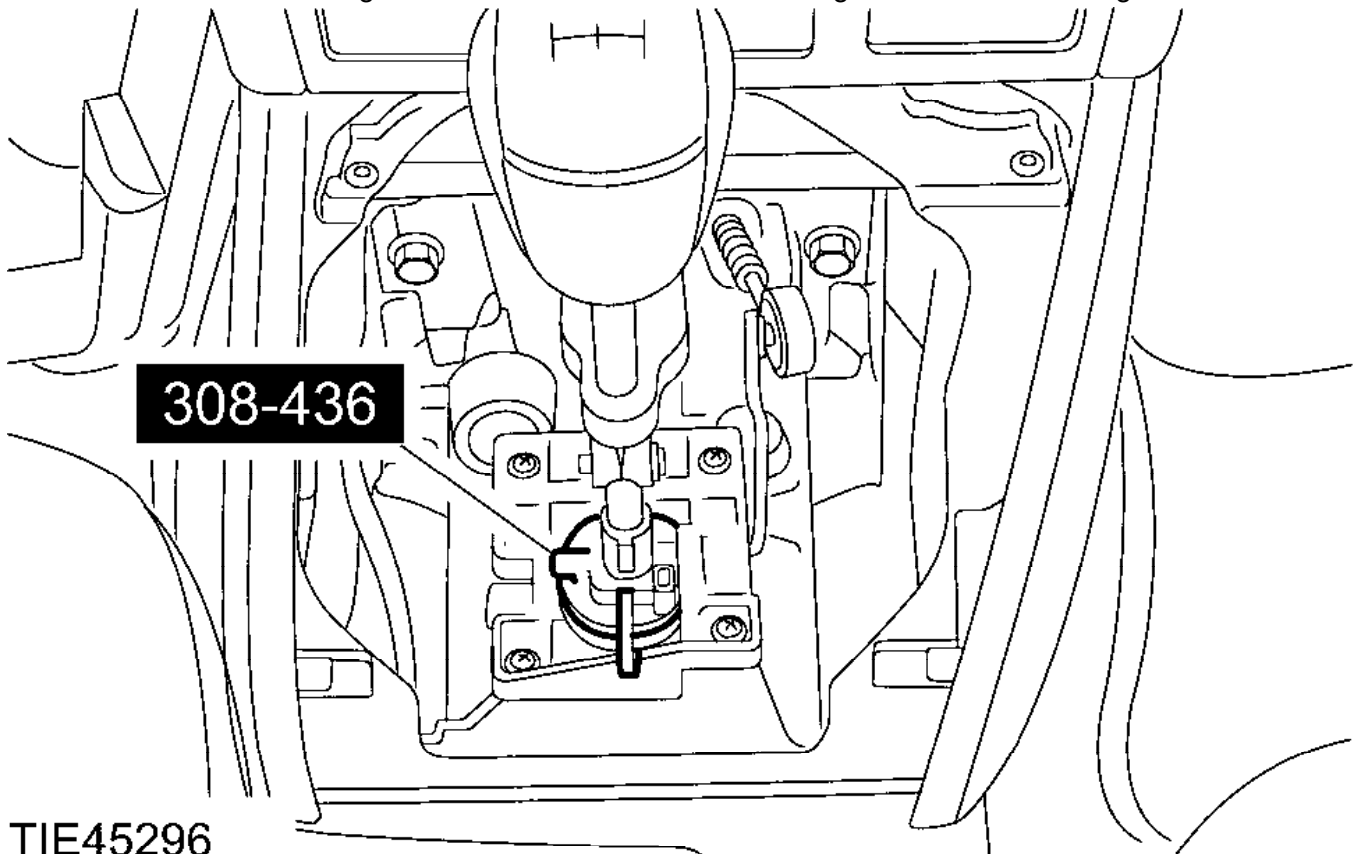

TIE45296

22. Remove the special tool.

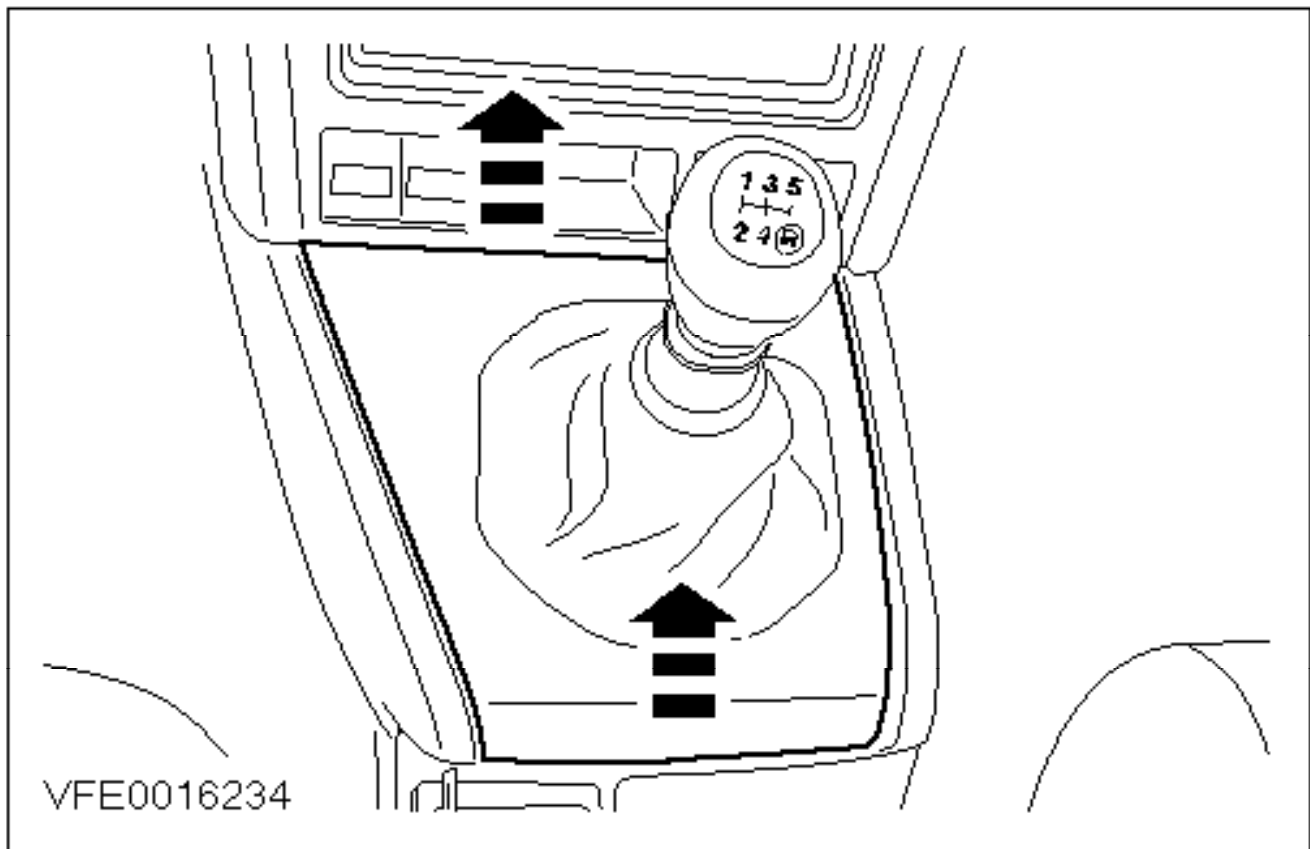

VFE0016234

All vehicles

23. Attach the gearshift lever gaiter and trim panel to the center console.
- Install the damping matting.

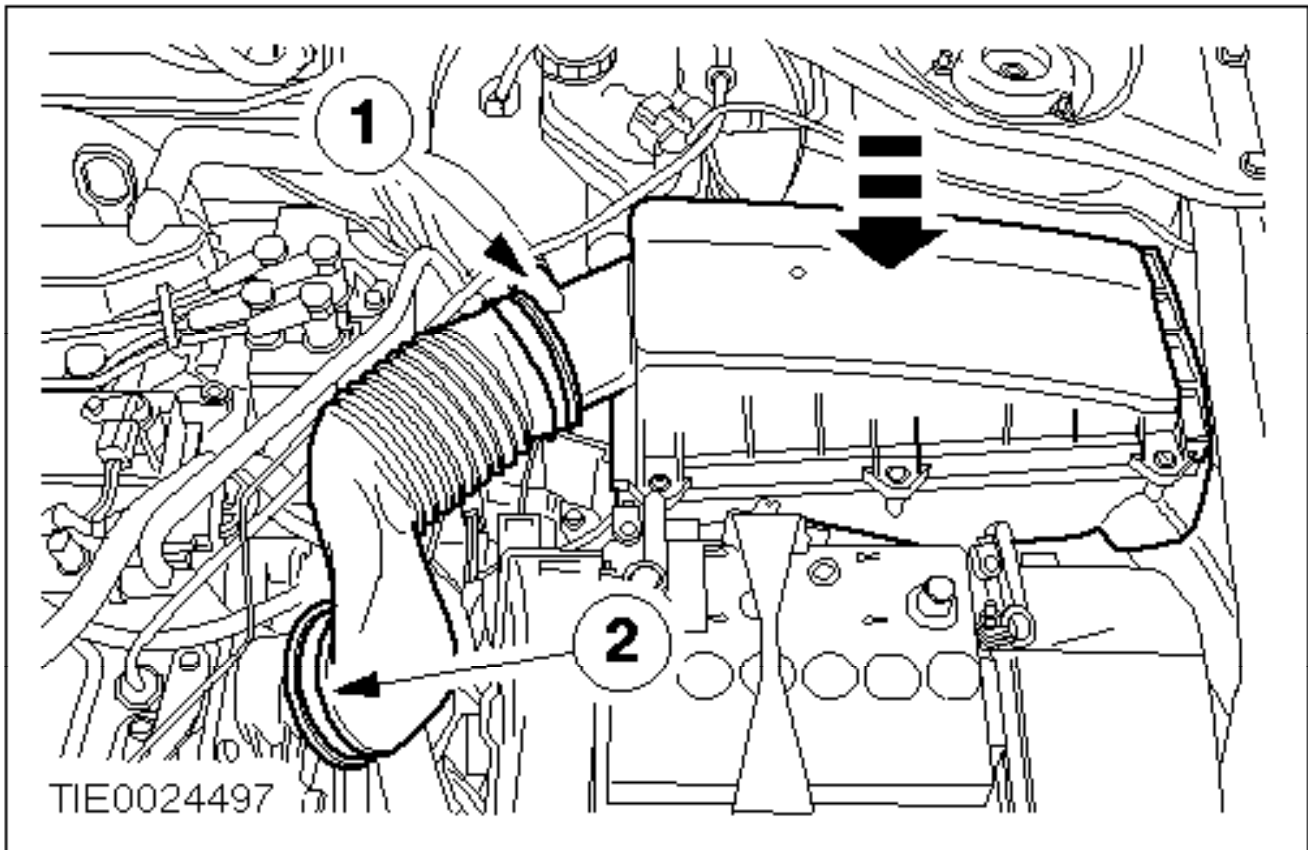

- 24. Install the air cleaner.
 - 1 Connect the positive crankcase ventilation (PCV) hose.
 - 2 Attach the air cleaner to engine intake hose clamp.

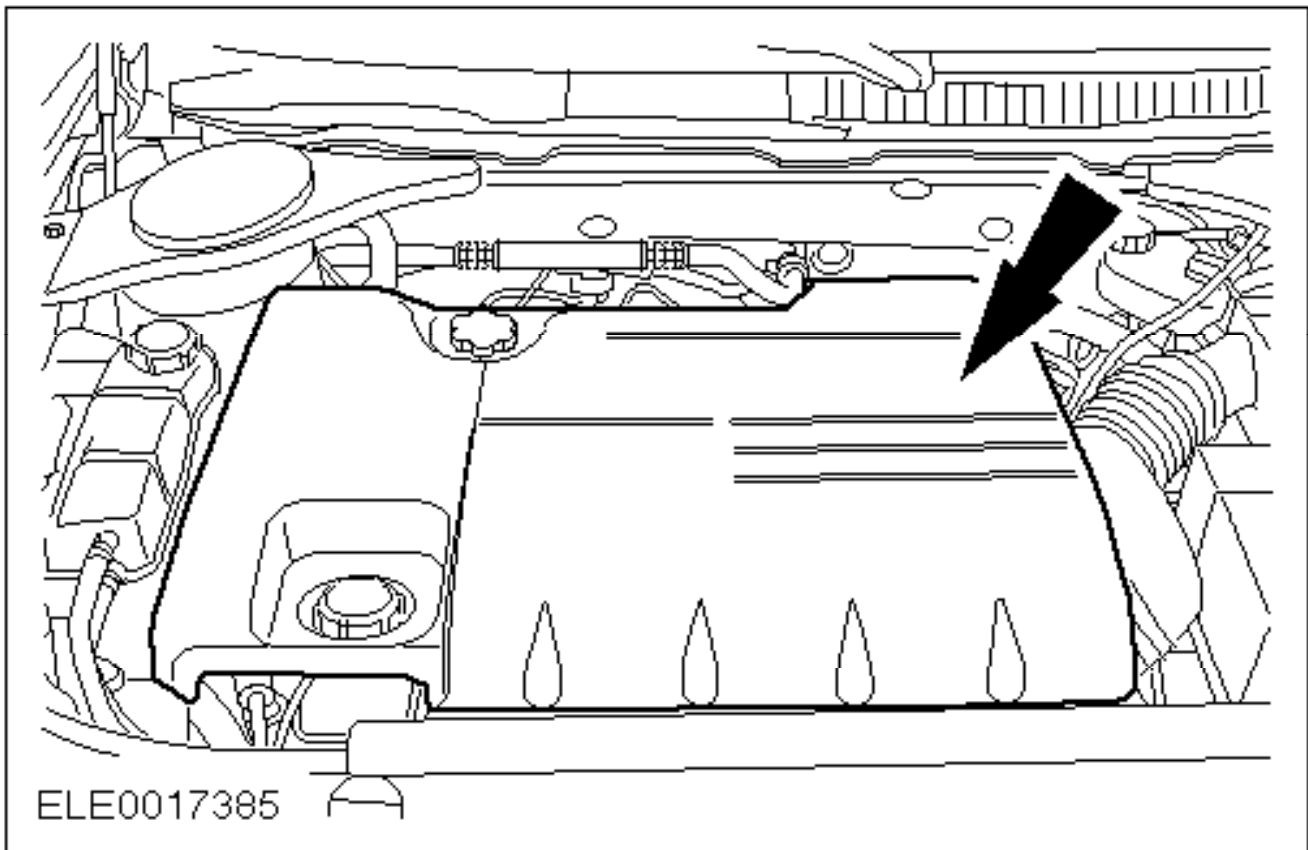

- 25. Install the engine cover.

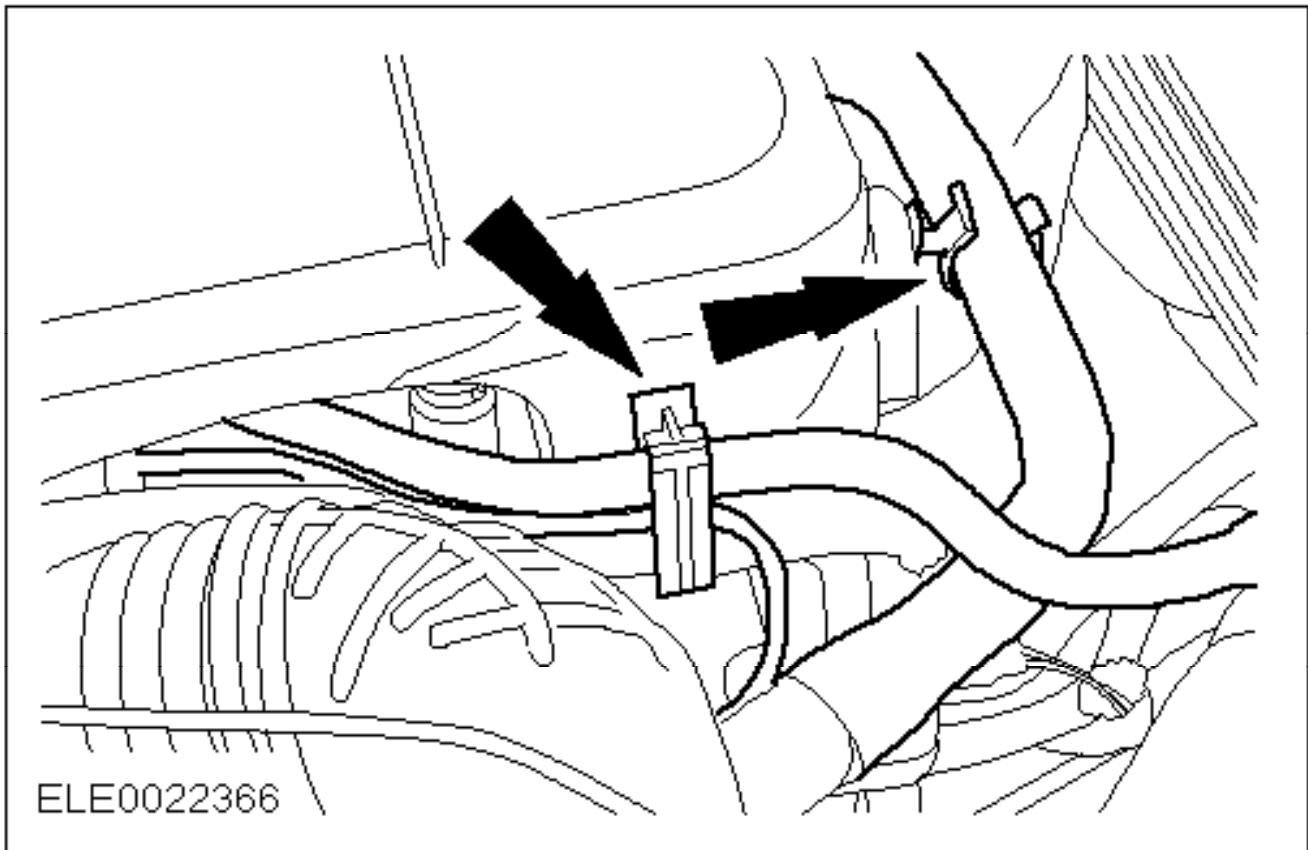

- 26. Attach the positive crankcase ventilation (PCV) hose and the vacuum hose to the engine cover.
-